

# STREET LIGHT: SG

## DATASHEET



SG is a high-performance street light independently developed by Edison and can flexibly provide lighting solutions according to needs. Its shell is formed by integrated high-quality ADC12 aluminum die-casting, and its excellent heat dissipation performance makes it have a longer life. IK09 tempered glass, IP66 waterproof grade increases its reliability. At the same time, it can be equipped with smart modules such as ZHAGA receptacle to meet the needs of different projects, and can provide smart solutions such as 0-10V dimming and DALI.

### Advantage

- Die-cast aluminium, efficient heat dissipation.
- Simple design, repels water and dust.
- Supports NEMA and ZHAGA smart control extensions.
- Tempered glass optical surface.
- Supports NEMA and ZHAGA smart control extensions.
- angle adjustment range  $\pm 15^\circ$  ,minimum adjustable scale  $5^\circ$

### Application

- Various roads
- parking lots
- parks
- squares

### Features

- Power: 40W-100W
- CCT: 3000K - 5700K
- Efficiency: 140LM/W
- IP66, IK09
- CB, CE, ENEC, ENEC+
- warranty 5years





## Table of Contents

|  |   |
|--|---|
| <b>Specification Information</b> ..... | 3 |
| <b>Accessories</b> .....               | 4 |
| <b>Dimensions</b> .....                | 5 |
| <b>Light Distribution Curve</b> .....  | 5 |
| <b>Packaging Information</b> .....     | 6 |
| <b>User Manual</b> .....               | 7 |
| <b>Revision History</b> .....          | 8 |
| <b>About Edison Opto</b> .....         | 8 |

## Specification Information

### • Optical parameters

| Model No.          | SG1-40W                 | SG1-60W | SG2-80W | SG2-100W |
|--------------------|-------------------------|---------|---------|----------|
| Power              | 40W                     | 60W     | 80W     | 100W     |
| Lumen              | 5600Lm                  | 8400Lm  | 11200Lm | 14000Lm  |
| Efficiency         | 140lm/W*                |         |         |          |
| CCT (Typ. K ± 10%) | 3000K, 4000K, 5700K     |         |         |          |
| CRI (Ra)           | ≥70                     |         |         |          |
| SDCM               | ≤6                      |         |         |          |
| Beam angle         | Type II , Type III **** |         |         |          |

### • Electrical parameters

|                  |   |
|------------------|---|
| Input voltage    | AC100-240V /220-240V 50-60Hz                                    |
| Power Factor     | 0.95  |
| Surge Protection | EDISON Isolated L-N: 4KV, MOSO:L-N: 5KV**,INVENTRONICS:L-N: 6KV |
| Dimmable         | 0-10V, PWM, Timer dimming (Optional)                            |

### • Mechanical parameters and key materials

|                 |  |
|-----------------|--|
| Housing         | High-pressure die-cast aluminum RAL9023 gray                       |
| Lens            | UV-resistant polycarbonate   |
| Cover           | Tempered glass   |
| LED Driver      | SG1 EDISON Isolated<br>SG2 MOSO (100-240V) INVENTRONICS (220-240V) |
| LED Brand/Model | EDISON5050   |

### • General parameters

|                       |                        |
|-----------------------|------------------------|
| Mounting              | Side entry or post-top |
| Operating Temperature | - 20 ~ + 50° C         |
| Storage humidity      | 10% ~ 85%              |
| Protection            | IP66, IK09             |
| Electrical class      | CLASS II               |
| Safety Approval       | CE, CB, ENEC,ENEC+**** |
| Lumen maintenance     | 50,000 hours at L70    |

\*Base on: 4000K

\*\*SPD 10KV/20KV is optional.

\*\*\*50W 70W 120W

\*\*\*\*Type I, Type IV, Type Vis optional.

Due to the special conditions of manufacturing process of LED, the typical data of technical parameters can only reflect statistical figures and do not necessarily correspond to the actual

## Accessories



60-76 adaptor



48mm adaptor



Wall bracket



Wiring connector (IP66)



Input cable



Photocell



ZHAGA receptacle



NEMA receptacle

## Dimensions

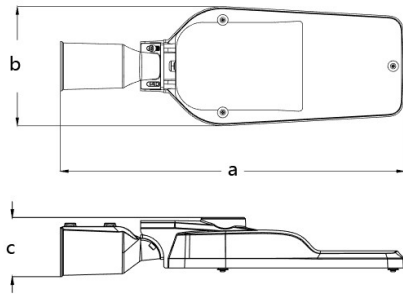

SG1



SG2

| Model No.                    | SG1     | SG2     |
|------------------------------|---------|---------|
| a                            | 520mm   | 675mm   |
| b                            | 180mm   | 197mm   |
| c                            | 90mm    | 91mm    |
| Pole diameter                | 55~60mm | 55~60mm |
| Pole diameter (with adaptor) | 48~76mm | 48~76mm |

## Light Distribution Curve

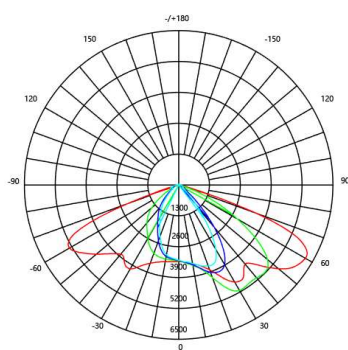

Type II

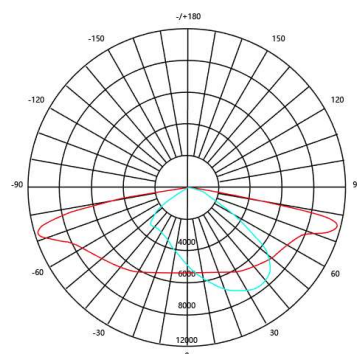

Type III

\*Other optical type is available according to special request.

## Packaging Information

| Model No.                | SG1           | SG2           |
|--------------------------|---------------|---------------|
| Packaging dimension (mm) | 590*250*310mm | 720*240*145mm |
| N. Weight ( kg )         | 5.2           | 3.8           |
| G. Weight ( kg )         | 6.1           | 4.8           |
| Packing                  | 2pcs/carton   | 1pc/carton    |

## User Manual

### Operative instructions

1 Choose how to install the street light if with the bracket in axis (Mode 1) or perpendicular to its body (Mode 2). The bracket can be released by removing the screws that attach to the street light.

2 Connect to the power line using IP66 connectors and respecting the connection diagram.

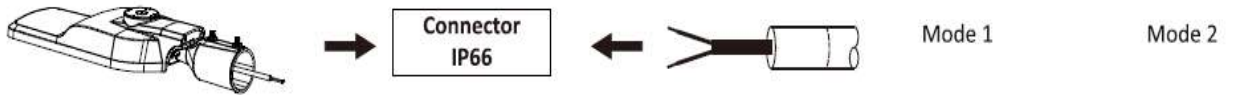

3 Insert the street light to the  $\varnothing 60\text{mm}$  pole, tightening the screws on it.

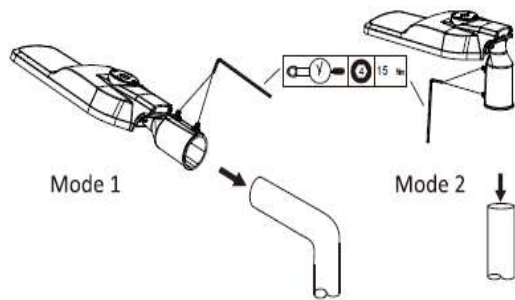

4 After selecting the Installation Mode, you can further orient the street light by some degree by sliding the screws on the grooves. ( $-15^{\circ}$ ~ $+15^{\circ}$ )

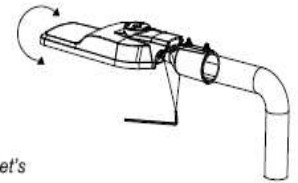

5 Finally, tighten definitively bracket's screws to ensure it to the street light.

## Revision History

| Versions | Description | Release Date |
|----------|-------------|--------------|
| 1.0      | NEW         | 2023/11      |

## About Edison Opto

Edison Opto provides comprehensive LED and solid-state lighting products from LED Component, Light Module, UV / IR LED, LED sensing, Horticulture and Automotive Lighting. With a view to improve R&D process, Edison Opto develops the vertical platform on **TEMO™** (Thermal. Electrical. Mechanical. Optical) to ensure the quality of products and services; Furthermore, Edison Opto creates **LDMS™** (Lighting Design Manufacturing Service) from light source to luminaire manufacturing, to serve our customers a quality experience of customized solutions.



Lear more